

TOP PLATE FOR WELDING CUSTOMER-SPECIFIC SIGN-MOUNTING HARDWARE

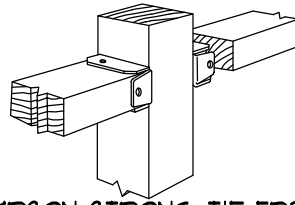

SIMPSON STRONG-TIE FB24Z
Scale = 2x

ENGINEER'S STAMP WILL BE PROVIDED UPON SALES AGREEMENT BETWEEN US AND OUR CLIENT.

OPTIONAL INSERTS FOR #6 WOOD SCREWS TO FASTEN OPTIONAL SIMPSON STRONG-TIE FB24Z FENCE RAIL HANGER PROVIDED ON (2) OPPOSITE SIDES AS SPECIFIED BY CUSTOMER.

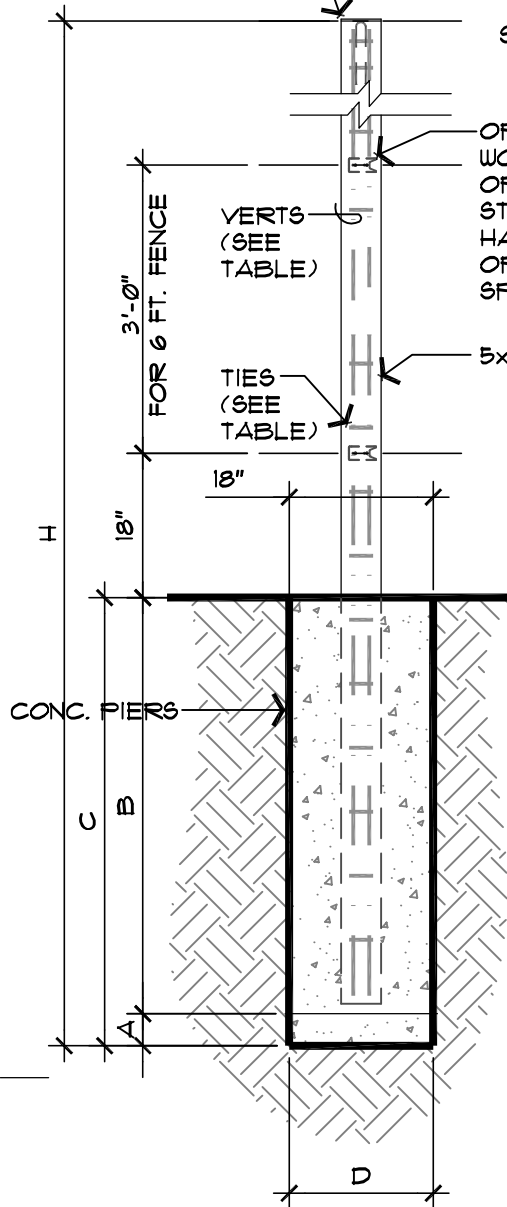

5x5 CONC. POSTS 100 MPH WINDS & DIMENSIONS FOR TRAFFIC SIGNS.

SIGN SIZES	SIGN AREA	H	A	B	C	D	VERTS	TIES
12"x18"	216 SQ. IN.	14'-0"	0'-4"	4'-4"	2'-0"	1'-0"	(4) #3	#3 @ 8" O.C.
18"x18"	324 SQ. IN.	14'-0"	0'-4"	2'-4"	2'-0"	1'-0"	(4) #3	#3 @ 8" O.C.
18"x24"	432 SQ. IN.	14'-0"	0'-4"	2'-4"	2'-0"	1'-0"	(4) #3	#3 @ 8" O.C.
24"x24"	576 SQ. IN.	14'-0"	0'-4"	3'-4"	3'-0"	1'-0"	(4) #3	#3 @ 8" O.C.
24"x30"	720 SQ. IN.	14'-0"	0'-4"	3'-4"	3'-0"	1'-0"	(4) #3	#3 @ 8" O.C.
30" STOP OCTAGONAL	746 SQ. IN.	14'-0"	0'-4"	3'-4"	3'-0"	1'-0"	(4) #3	#3 @ 8" O.C.
30"x30"	900 SQ. IN.	14'-0"	0'-4"	3'-4"	3'-3"	1'-0"	(4) #3	#3 @ 8" O.C.
24"x48"	1152 SQ. IN.	14'-0"	0'-4"	3'-4"	3'-6"	1'-0"	(4) #3	#3 @ 8" O.C.
48"x96"	4608 SQ. IN.	14'-0"	0'-4"	5'-2"	4'-9"	1'-6"	(4) #4	#3 @ 8" O.C.

NOTE: WIND LOADS DO NOT APPLY TO ATTACHED FENCES - ONLY TO SIGN AND POST. CUSTOMER IS RESPONSIBLE FOR PROPER INSTALLATION AND COMPLIANCE WITH RECOMMENDED SIGN SIZES FOR THIS POST UNDER ACTUAL WIND/WEATHER CONDITIONS IN THE AREA IN WHICH THE POST AND SIGN ARE INSTALLED. THE ENGINEER OF RECORD AND EISEN CONCRETE POST WILL NOT BE RESPONSIBLE FOR INSTALLATIONS DONE IMPROPERLY BY THE CUSTOMER OR HIS CONTRACTOR.

CONC. PIER FTG./ POST CONN

SCALE : 1/2" = 1'-0"

6-22-10 12:29pm
Poste_5x5x14pies.dwg
Plotted by bill
GBC layer group = 1

COPYRIGHT © 2010 EISEN CONCRETE POST

EISEN

CONCRETE POST

889 RISLEY AVE., GLADSTONE, OR 97027

PHONE: 503-819-5750